

vtech®

Parent's Guide

SWITCH&GO® **DiNOS** *Sandstorm the Stegosaurus*

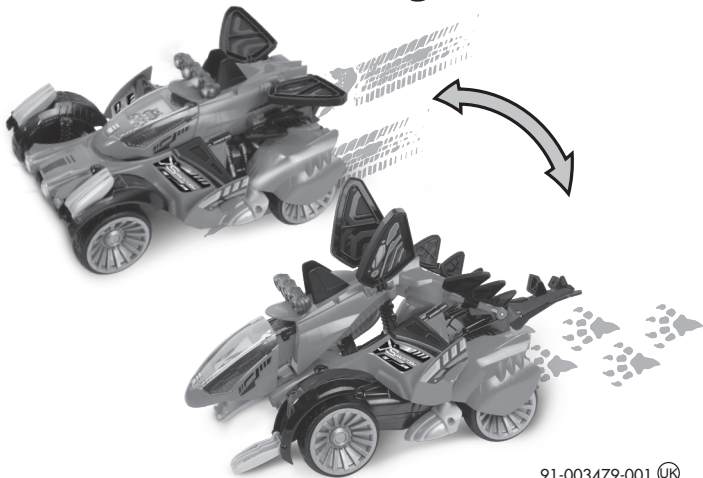

91-003479-001 (UK)

VTech understands that a child's needs and abilities change as they grow and with that in mind we develop our toys to teach and entertain at just the right level...

vtech Baby

Toys that will stimulate their interest in different textures, sounds and colours

I am...

...responding to colours, sounds and textures

...understanding cause and effect

...learning to touch, reach, grasp, sit-up, crawl and toddle



Birth-36 months

Pre-School

Interactive toys to develop their imagination and encourage language development

I want...

...to get ready for school by starting to learn the alphabet and counting

...my learning to be as fun, easy and exciting as can be

...to show my creativity with drawing and music so my whole brain develops



3-6 years

Electronic Learning Computers

Cool, aspirational and inspiring computers for curriculum related learning

I need...

...challenging activities that can keep pace with my growing mind

...intelligent technology that adapts to my level of learning

...National Curriculum based content to support what I'm learning at school



4-10 years

To learn more about this and other VTech® products, visit www.vtech.co.uk

INTRODUCTION

Thank you for purchasing **VTech® Switch & Go Dinos® Sandstorm the Stegosaurus!** Sandstorm can be switched between a mighty Stegosaurus and a cool beach buggy! Let's go and explore!

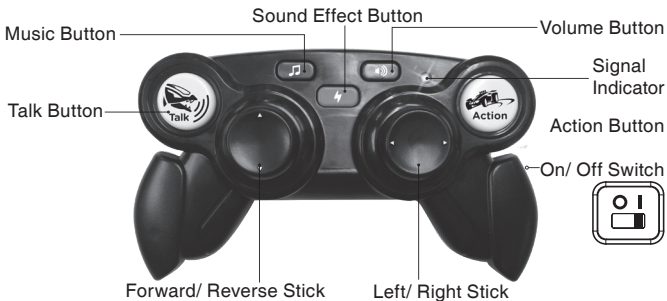
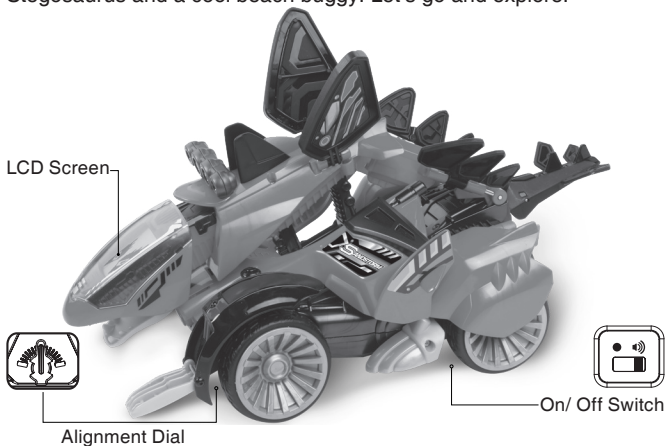

INCLUDED IN THIS PACKAGE

- One **Sandstorm the Stegosaurus**
- One remote control
- One parent's guide

WARNING:

All packing materials such as tape, plastic sheets, packaging locks, removable tags, cable ties and packaging screws are not part of this toy, and should be discarded for your child's safety.

NOTE:

1. Please keep this parent's guide as it contains important information.
2. For optimal performance, please use Sandstorm the Stegosaurus on a flat, smooth surface.
3. When exposed to electrostatic discharge and radio interference, Sandstorm the Stegosaurus may malfunction. Please turn both Sandstorm and the remote control off and on again to reset them.

IMPORTANT NOTE:

For your child's safety, only use Sandstorm the Stegosaurus on hard, flat surfaces. Do not put Sandstorm in either configuration on your clothing, body or hair.

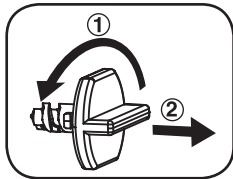
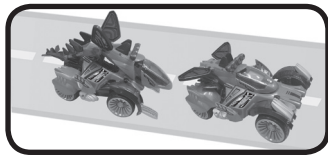

Unlock the packaging locks:

- ① Turn the packaging lock anticlockwise several times.
- ② Pull out and discard the packaging lock.

GETTING STARTED

BATTERY INSTALLATION

1. Make sure Sandstorm the Stegosaurus and the remote control are turned **OFF**.
2. Locate the battery covers on the back of Sandstorm the Stegosaurus and of the remote control. Use a screwdriver to loosen the screws.
3. Install 6 new AA (LR06/AM-3) batteries following the diagram inside the battery box of Sandstorm the Stegosaurus. Then, install 2 new AAA (LR03/AM-4) batteries following the diagram inside the battery box of the remote control. (The use of new alkaline batteries is recommended for maximum performance).
4. Replace the battery covers to secure them.

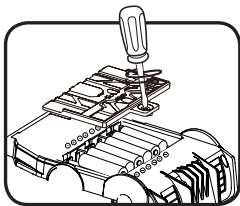

Sandstorm the Stegosaurus

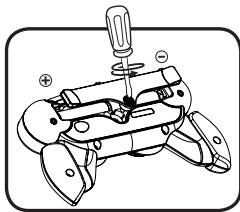

Remote Control

BATTERY NOTICE

- Use new alkaline batteries or fully charged NI-MH (Nickel Metal-hydride)
- Use only batteries of the same or equivalent type as recommended.
- Do not mix different types of batteries: alkaline, standard (carbon-zinc) or rechargeable, or new and used batteries.
- Do not use damaged batteries.
- Insert batteries with the correct polarity.
- Do not short-circuit the battery terminals.
- Remove exhausted batteries from the toy.
- Remove batteries during long periods of non-use.
- Do not dispose of batteries in fire.
- Do not charge non-rechargeable batteries.
- Remove rechargeable batteries from the toy before charging (if removable).
- Rechargeable batteries are only to be charged under adult supervision.

Disposal of batteries and product



The crossed-out wheellie bin symbols on products and batteries, or on their respective packaging, indicates they must not be disposed of in domestic waste as they contain substances that can be damaging to the environment and human health.



The chemical symbols Hg, Cd or Pb, where marked, indicate that the battery contains more than the specified value of mercury (Hg), cadmium (Cd) or lead (Pb) set out in Battery Directive (2006/66/EC).

The solid bar indicates that the product was placed on the market after 13th August, 2005.

Help protect the environment by disposing of your product or batteries responsibly.

For more information, please visit:

www.recycle-more.co.uk

www.recyclenow.com

PRODUCT FEATURES

1. ON/ OFF SWITCH

Slide the **REMOTE CONTROL ON/OFF SWITCH** to **I** to turn the **REMOTE CONTROL ON**.

Slide the Sandstorm the Stegosaurus **ON/OFF SWITCH** to **⏻** to turn Sandstorm **ON**. The **REMOTE CONTROL** and Sandstorm the Stegosaurus must both be turned on to send and receive signals.

Slide the **ON/OFF SWITCH** on the **REMOTE CONTROL** to **O** to turn it **OFF**.

Slide the **ON/OFF SWITCH** on Sandstorm the Stegosaurus to **●** to turn Sandstorm **OFF**.



2. TALK BUTTON

Press the **TALK BUTTON** on the **REMOTE CONTROL** to hear cool phrases and dinosaur facts.



3. MUSIC BUTTON

Press the **MUSIC BUTTON** on the **REMOTE CONTROL** to hear different short tunes.



4. SOUND EFFECT BUTTON

Press the **SOUND EFFECT BUTTON** on the **REMOTE CONTROL** to hear cool sound effects.



5. VOLUME BUTTON

Press the **VOLUME BUTTON** on the **REMOTE CONTROL** to adjust the volume.



6. SIGNAL INDICATOR ON THE REMOTE CONTROL

The **SIGNAL INDICATOR** will flash once when a button is pressed. It will light up when any button on the remote control is held down.

NOTE: If the signal indicator is not lighting up when any button is pressed, please replace the batteries of remote control with new ones.

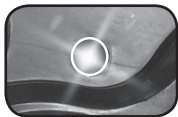

7. ACTION BUTTON

Press the **ACTION BUTTON** on the **REMOTE CONTROL** to see cool moves.



8. FORWARD/ REVERSE STICK

Press the **FORWARD/REVERSE STICK** on the **REMOTE CONTROL** to see Sandstorm the Stegosaurus move forwards or backwards.

NOTE: If Sandstorm the Stegosaurus is not moving straight, use the **ALIGNMENT DIAL** to adjust the front wheel alignment.



9. LEFT/ RIGHT STICK

Press the **LEFT/RIGHT STICK** on the **REMOTE CONTROL** to make the front wheels turn left/right. When Sandstorm is going forwards or backwards, hold the **LEFT/RIGHT STICK** to turn left or right.

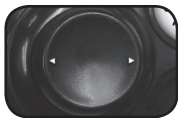

10. AUTOMATIC SHUT OFF

To preserve battery life, Sandstorm the Stegosaurus will shut off automatically after several minutes without input. When Sandstorm the Stegosaurus shuts off automatically, it will not receive any signal sent by the remote control. Sandstorm can be turned on again by sliding the **ON/OFF SWITCH** to the off, then the on position.

Sandstorm the Stegosaurus and the **REMOTE CONTROL** will automatically shut off when their respective batteries are low on power. For Sandstorm the Stegosaurus, a low power battery indicator will be shown on screen as a reminder.

Note: If Sandstorm repeatedly shuts off or has abnormal responses when switched on, please install new batteries and try switching Sandstorm on again.

ACTIVITIES

1. Dino Mode

Play and learn about Stegosaurus facts, hear short tunes and sound effects. Press the Action Button to see cool moves!

2. Vehicle Mode

Play with the beach buggy and enjoy sound effects with varied light patterns. Press the Action Button to see cool moves!

TRANSFORMATION

1. From Dino to Vehicle

Firstly, push the tail down.

Secondly, grip under the two front wheels with one hand.

Thirdly, use another hand to push the top lights towards tail until the head locks and rests into the body.

Finally, flip up the front claws.

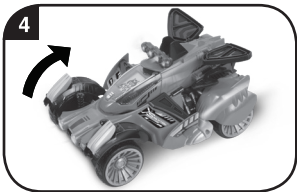
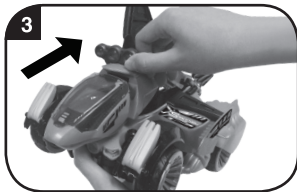
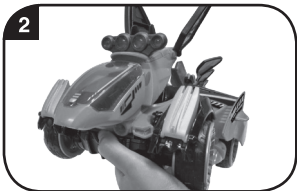

Note: If the head could not lock and rest into the body, please use two hands to hold and grip the front and rear legs. Then, pull them firmly in opposite directions until the head locks and rests into the body.



2. From Vehicle to Dino

Firstly, pull the tail up to pop out the head.

Secondly, fold down the front claws.

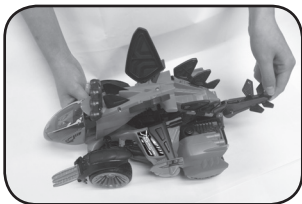

CARE & MAINTENANCE

1. Keep Sandstorm the Stegosaurus and the remote control clean by wiping them with a slightly damp cloth.
2. Keep Sandstorm the Stegosaurus and the remote control out of direct sunlight and away from any direct heat source.
3. Remove the batteries when Sandstorm the Stegosaurus and the remote control are not in use for an extended period of time.
4. Do not drop the Sandstorm or the remote control on hard surfaces and do not expose either of them to moisture or water.

TROUBLESHOOTING

If for some reason Sandstorm stops working or malfunctions, please follow these steps:

1. Please turn Sandstorm **OFF**.
2. Interrupt the power supply by removing the batteries.
3. Let Sandstorm sit for a few minutes, then replace the batteries.
4. Turn Sandstorm **ON**. Sandstorm should now be ready to play with again.
5. If Sandstorm still does not work, install a brand new set of batteries.

If the problem persists, please call our Consumer Services Department on 0330 678 0149 (from UK) or +44 330 678 0149 (outside UK) and a service representative will be happy to help you.

IMPORTANT NOTE:

Creating and developing **VTech®** products is accompanied by a responsibility that we at **VTech®** take very seriously. We make every effort to ensure the accuracy of the information which forms the value of our products. However, errors sometimes can occur. It is important for you to know that we stand behind our products and encourage you to call our Consumer Services Department on 0330 678 0149 (from UK) or +44 330 678 0149 (outside UK) with any problems and/or suggestions that you might have. A service representative will be happy to help you.

DECLARATION OF CONFORMITY

Hereby, VTech Electronics Europe BV declares that the radio equipment type of the above models are in compliance with Directive 2014/53/EU. The full text of the EU declaration of conformity is available at the following internet address: www.vtech.com/re-directive

Manufacturer Name: VTech Electronics Europe BV

Manufacturer address: PO Box 10042, 6000 GA Weert, The Netherlands

Radio Frequency Band : 2413-2473 MHZ

Maximum RF power : -3.8dBm (MAX)

CLASS 1
LED PRODUCT





PRODUCT REGISTRATION

Visit www.vtech.co.uk/clubvtech/login
to register your VTech product

By joining the VTech Club you can also enter competitions, find out about news and events, seek expert advice for parents and let your kids play fun learning games and activities.



PRODUCT WARRANTY

Thank you for choosing this quality product from VTech. We hope it will bring many hours of entertainment, imaginative play and learning.

1. The product detailed above is covered by a one year warranty from the date of purchase, against any defects in materials or workmanship.
2. The product may be returned to the place of purchase. Alternatively the product can be returned to VTech Electronics Europe plc (see address below), with proof of purchase, without proof of purchase no replacement will be provided.
3. VTech Electronics Europe plc will examine the product and if it is found to be defective due to faulty materials or workmanship, will replace the product at their discretion.
4. If the product covered by this warranty is damaged due to misuse, modification or unauthorised repair, or because of faulty batteries, battery discharge or incorrect electrical connections, then this warranty becomes void.
5. This warranty is personal to the original purchaser and is not transferable.
6. Breakages to the LCD screen are not covered by the warranty.
7. Returns to VTech Electronics Europe plc should include a cheque or postal order for £1.50 towards the cost of return postage and packaging.
8. Products returned to VTech Electronics Europe plc, should be addressed as follows and packed carefully to avoid damage in transit (Please do not include batteries or adaptor). Please include details of the fault together with your name and address.
9. To keep an online record of your warranty, please register your product online at www.vtech.co.uk/warranty

Vtech Electronics EU PLC, c/o XPO Logistics, Warehouse 350, Cat & Fiddle Lane, West Hallam, DE7 6HE

THIS WARRANTY IS OFFERED AS AN EXTRA BENEFIT AND DOES NOT AFFECT CONSUMERS' STATUTORY RIGHTS.

This warranty is valid for the UK and Eire only. For products purchased outside the UK and Eire, please contact your local distributor or place of purchase.

**Visit our website for more
information about our products,
downloads, resources and more.**

www.vtech.co.uk



TM & © 2018 VTech Holdings Limited.
All rights reserved
Printed in China
91-003479-001 